

(These items were developed by teachers for the Technical Skills Assessment. Below is a sample item for each program standard.)

Question 1 of 9

Which tool is used to draw circles and arcs?

- A) Compass
- B) Dividers
- C) Irregular curve
- D) Protractor

Question 2 of 9

What is it called when a grid divides the area into small parts on a grinding system?

- A) Segments
- B) Bays
- C) Section
- D) Pods

Question 3 of 9

What function opens a plan file that is CAD program compatible to .dwg or .dxf?

- A) Scanning
- B) Export
- C) Xerox copy
- D) Duplicate

Question 4 of 9

What CADD command produces an exact opposite image of the selected entities?

- A) Array
- B) Align
- C) Mirror
- D) Offset

Question 5 of 9

What are the vertical faces that run from one tread to the next?

- A) Stringers
- B) Studs
- C) Headroom
- D) Risers

Question 6 of 9

What is a typical angle used in vertical lettering?

- A) 22.5 degrees
- B) 90 degrees
- C) 45 degrees
- D) 75 degrees

Question 7 of 9

Which roof type is MOST suited to houses in cold, wet, snowy climates?

- A) Hip
- B) Flat
- C) Shed
- D) A-frame

Question 8 of 9

Which rooms are indicated in the cross section?

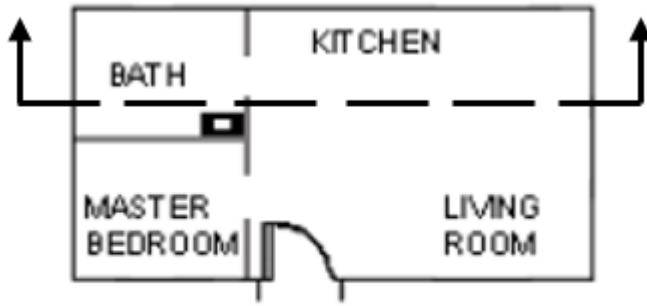

FLOOR PLAN

- A) Living room, master bedroom
- B) Kitchen, bathroom
- C) Master bedroom, kitchen
- D) Bathroom, master bedroom

Question 9 of 9

What type of drawing provides the BEST OVERALL representation of the shape and style of a structure?

- A) Auxiliary
- B) Two-dimensional detailed
- C) Three-dimensional
- D) Elevation

Architectural Drafting Sample Test Answer Key

Question	Answer
1.	A
2.	B
3.	B
4.	C
5.	D
6.	B
7.	D
8.	B
9.	C